

# PA01

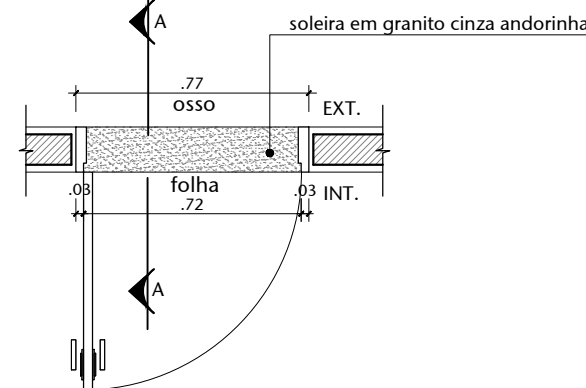

01 PA01-PLANTA BAIXA  
ESCALA 1/25

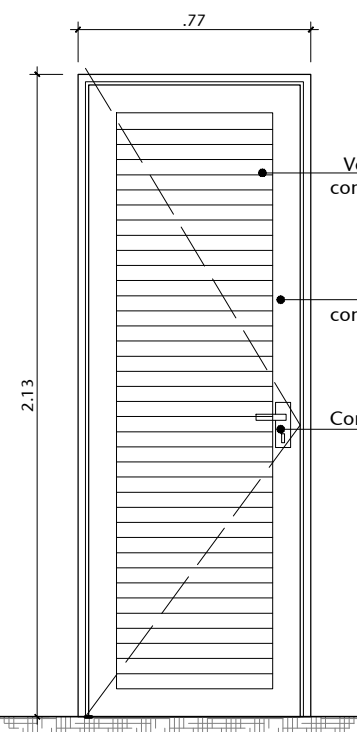

02 PA01-VISTA  
ESCALA 1/25

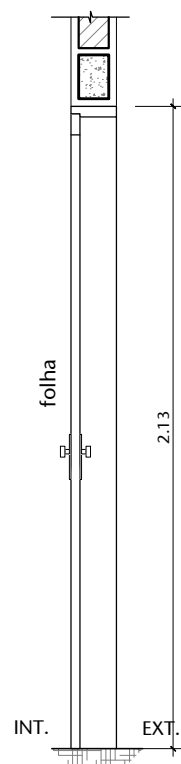

03 PA01- CORTE AA  
ESCALA 1/25

# PM02

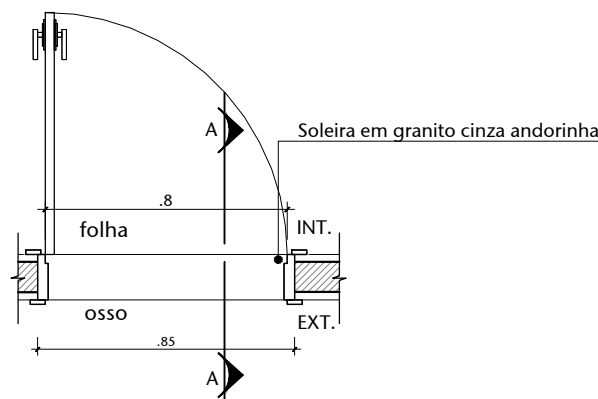

04 PM02-PLANTA  
ESCALA 1/25

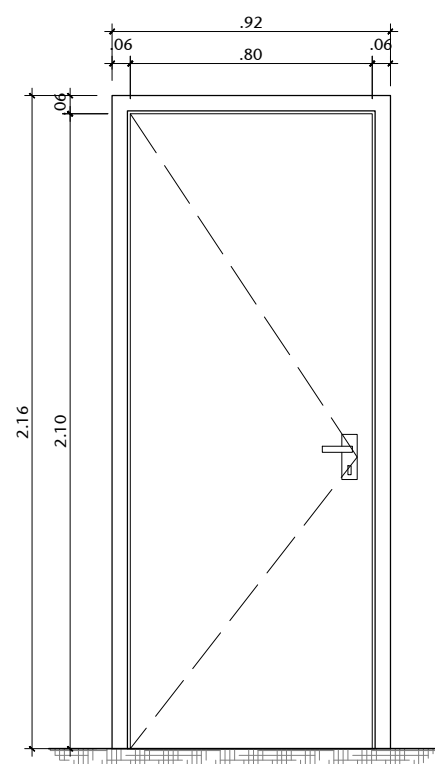

05 PM01-VISTA  
ESCALA 1/25

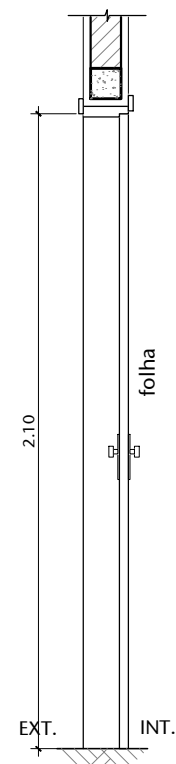

06 PM01-CORTE AA  
ESCALA 1/25

# JV01

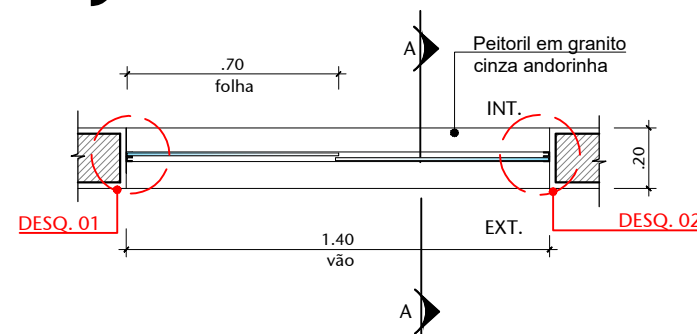

07 JV01-PLANTA  
ESCALA 1/25

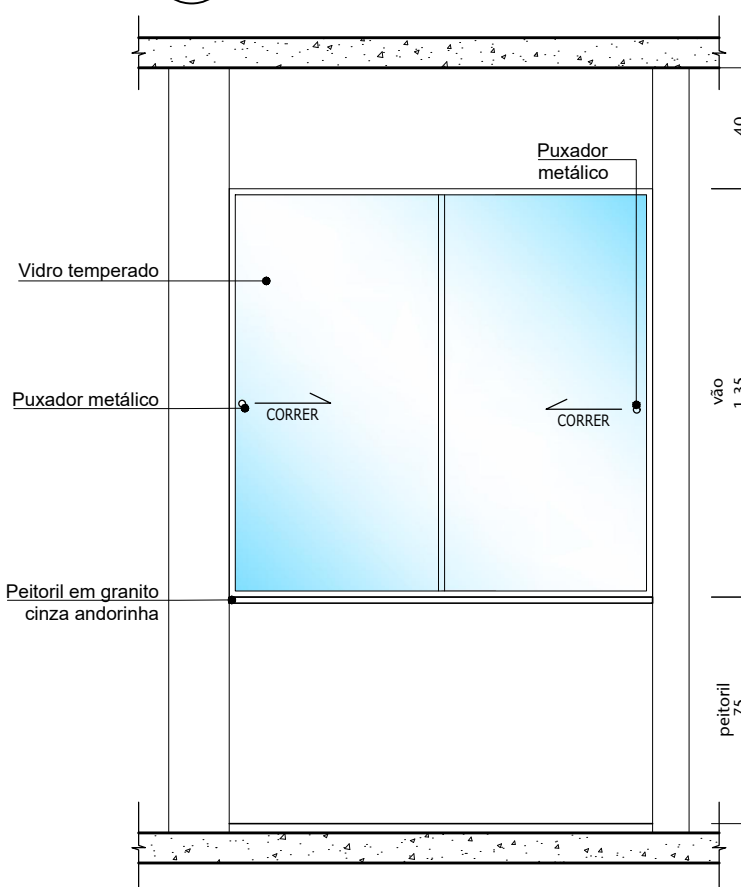

08 JV01-VISTA  
ESCALA 1/25



09 JV01-CORTE AA  
ESCALA 1/25

# JV02

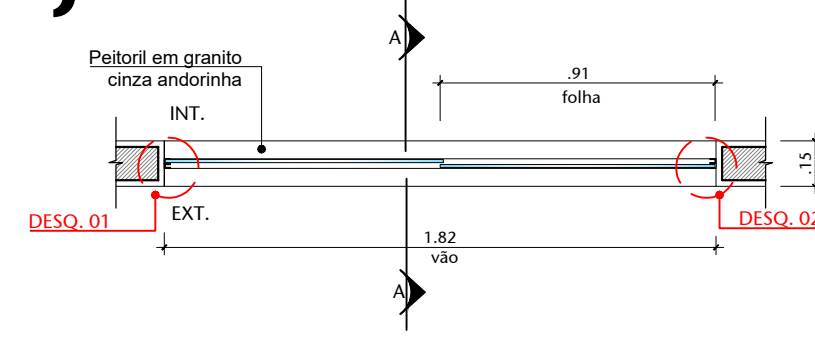

10 JV02-PLANTA  
ESCALA 1/25

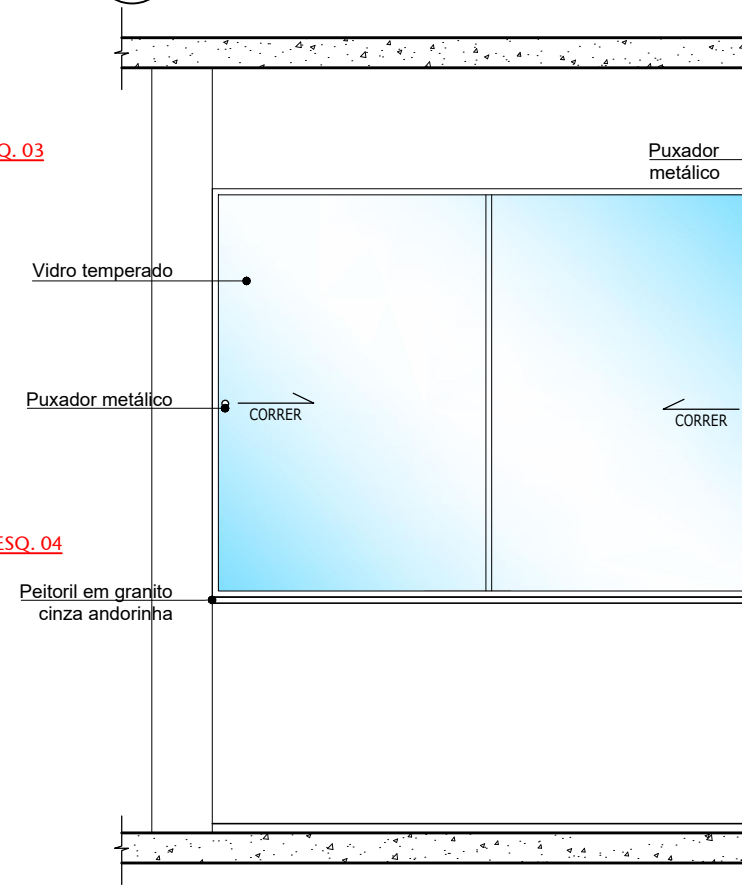

11 JV02-VISTA  
ESCALA 1/25

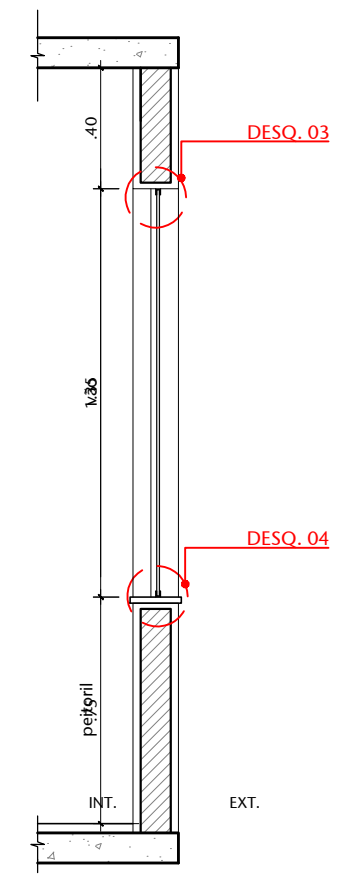

12 JV02-CORTE AA  
ESCALA 1/25

# JV03

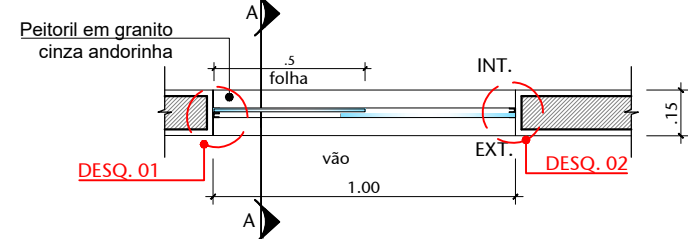

13 JV03-PLANTA  
ESCALA 1/25

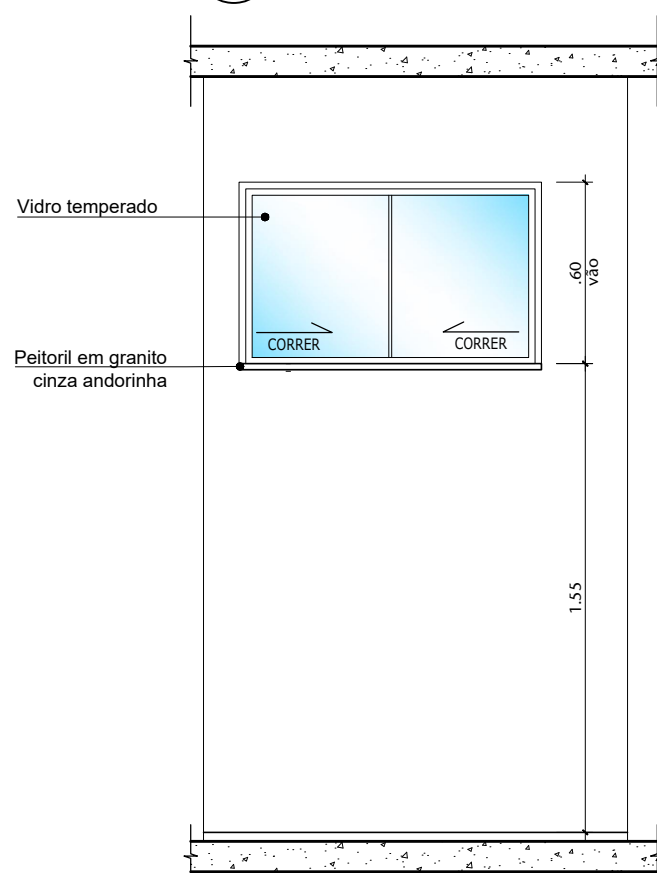

14 JV03-VISTA  
ESCALA 1/25

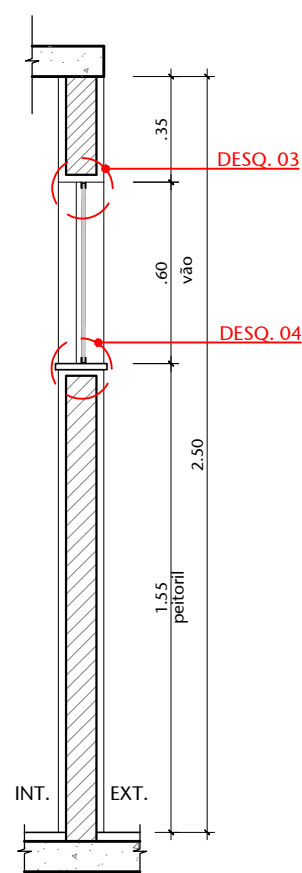

15 JV03-CORTE AA  
ESCALA 1/25

# JV04

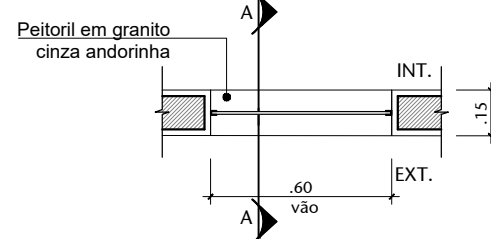

16 JV04-PLANTA  
ESCALA 1/25

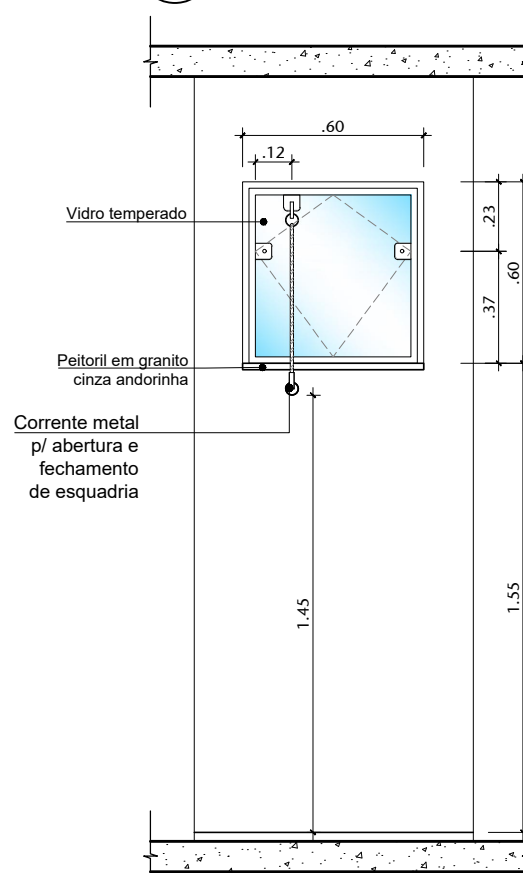

17 JV04-VISTA  
ESCALA 1/25

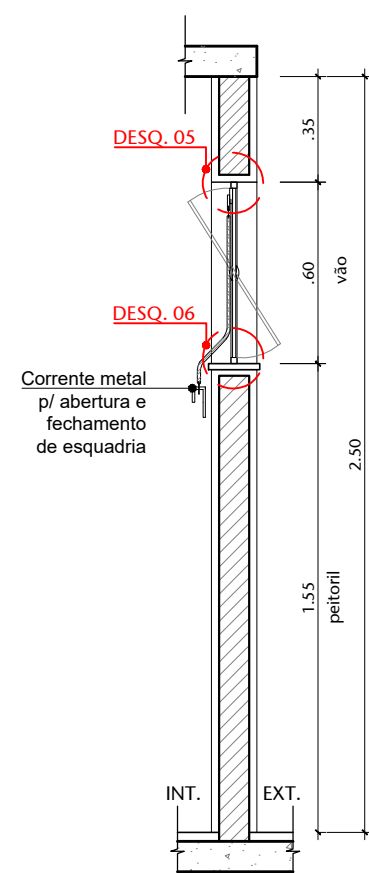

18 JV04-CORTE A  
ESCALA 1/25

TABELA DE ESQUADRIAS

ITEM	QTD.	DESCRIÇÃO
PA01	01	Porta de abrir com Lambri Horizontal - Alumínio 77x210cm com acabamento em pintura eletrostática branca com veneziana + soleira em granito cinza andorinha, Sasazaki ou similar
PM01	01	Porta em madeira 80 cm, revestida em laminado branco
JV01	02	janela de correr em vidro temperado, com película fumê, 140(C) x 135(A) x 75(peitoril) - BLINDEX
JV02	02	janela de correr em vidro temperado, com película fumê, 182(C) x 135 (A) x 75(peitoril) - BLINDEX
JV03	01	janela de correr em vidro temperado, com película fumê, 140(C) x 60(A) x 155(peitoril) - BLINDEX
JV04	01	janela basculante em vidro temperado, com película fumê, 60(C) x 60(A) x 155(peitoril) - BLINDEX

01	REVISÃO DE NÍVEIS	03/08/2020	NATACHA
00	EMIÇÃO INICIAL	22/06/2018	FERNANDA B
Nº	CONTROLE DE EMISSÃO DE DESENHOS	DATA	REVISOR

SENADO FEDERAL

SECRETARIA DE INFRAESTRUTURA

COORDENAÇÃO DE PROJETOS E REFORMA



INTERESSADO:		LOCAL: GUARITA SEGRAF	ÁREA DE INTERV.
SPSF-SECRETARIA DE POLÍCIA LEGISLATIVA		VIO1-SEGRAF-CASF	175.0M²

COORD.	CHEFE DE SERV.:	TAREFA:	PROJETO:	FASE:	Nº PRANCHA:
RONILDO	GUILHERME	#40751	REFORMA DA GUARITA SEGRAF	PROJETO BÁSICO	13/19
ARQUITETO:	DESENHO:	DATA:	TÍTULO DA PRANCHA:	ESCALA:	
FERNANDA B.	LARISSA/GIOVANA	15/08/2018	DETALHAMENTO DE ESQUADRIAS	1/25	